

CERTIFIED LAND CORNER RECORDATION

DESCRIPTION OF CORNER EVIDENCE FOUND, AND ORIGINAL RECORD (If known)

Found Gray Stone in North-South fence line to North side of fence corner, Found 1/2" rebar 1.5' East of stone.

DESCRIPTION OF MONUMENT AND ACCESSORIES ESTABLISHED TO PERPETUATE THE ORIGINAL LOCATION OF THIS CORNER:

See sketch below.

SKETCH, WITH COURSE AND DISTANCE TO ADJACENT CORNER IF DETERMINED IN THIS SURVEY.
(May Sketch or Paste Reproduction on Reverse Side.)

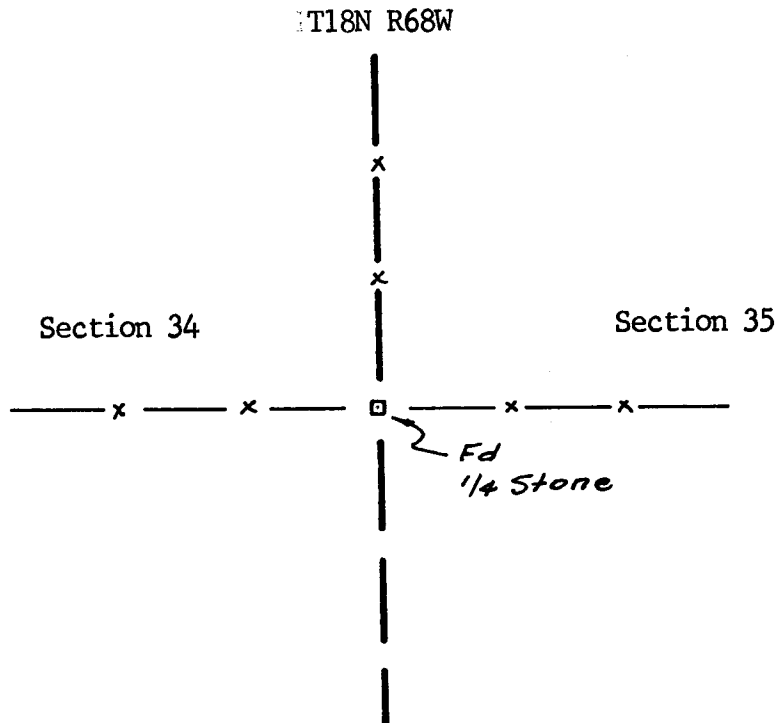

I, Albert Scott certify that I have carefully performed or reviewed the work done on the diagrammed corner as reported on this recordation form and approve the same.

Albert Scott
Signature of Surveyor

L.S. 2573
Registration No.

STATE OF WYOMING,
Office of Clerk and Recorder,
County of _____

567567

This "corner record" was filed for record on the _____ day of _____, **FEB 12 1980**, 19____, was noted on the cross-index plat and is assigned page No. _____, in book No. _____.

James C Whitehead
County Official 6th P.M.

Cross Index No. <u>X17</u>	T. <u>18N</u>	R. <u>68W</u>	Mer.
_____	T. _____	R. _____	Mer.
_____	T. _____	R. _____	Mer.
_____	T. _____	R. _____	Mer.
_____	T. _____	R. _____	Mer.
_____	T. _____	R. _____	Mer.
_____	T. _____	R. _____	Mer.